

Caribbean Dream Reversible Tossed Pillows



Pillows designed by Patti Carey Stonehenge Maui, Stonehenge Mojave, and Stonehenge Caribbean fabrics designed by Sunshine Cottage for Northcott Silk

MATERIALS

- 1/8 yd. marbled dark green (#3938-40)
- 1/4 yd. each of three different marbled dark blue/greens (#s 3934-38, 3951-97, and 3953-100)*
- 1/4 yd. each of four different marbled light blue/greens (#s 3937-44, 3937-45, 3954-98, and 3953-99)*
- 7/8 yd. marbled pale sea foam (#3937-41)
- Two 18" square pillow forms or enough polyester fiberfill to stuff two 18" square pillows
- Thread in colors to match fabrics
- Basic sewing and rotary cutting supplies

**Only 1/8 yd. is required if using leftover half-square triangle units from the Caribbean Dream quilt featured in the Summer 2010 issue.*

CUTTING

From the marbled dark green:

Two 1½" x 42" strips; recut into four 1½" x 14½" strips (for Striped block)

From the marbled dark blue/green and light blue/green, cut a total of:

Twelve 3½" light squares; cut diagonally in half (for Ocean Wave block)*

Twelve 3½" dark squares; cut diagonally in half (for Ocean Wave block)*

Sixteen assorted light and dark 2" x 14½" strips (for Striped block)

From the marbled pale sea foam:

One 6⅛" x 42" strip; recut into two 6⅛" squares, then cut diagonally in half, and two 4½" x 11" strips (for Ocean Wave block)

Four 4½" x 42" strips; recut two strips into four 4½" x 19" strips, and each remaining strip into one 4½" x 11" strip (for Ocean Wave block) and two 2¾" x 14½" strips (for Striped block)

One 2¾" x 42" strip; recut into two 2¾" x 19" strips (for Striped block)

* If using leftover half-square triangle units, cut only four 3½" light blue/green triangles and four 3½" dark blue/green triangles.

DIRECTIONS

Ocean Wave Block Assembly

1. Half-square triangle units. Gather 20 of the leftover half-square triangle units reserved from step 1 of the *Caribbean Dream* quilt on page 22 of the Summer 2010 issue or, follow **Diagram 1** to make a total of twenty 3⅛" x 3⅛" half-square triangle units by sewing a 3½" light blue/green triangle to each of twenty 3½" dark blue/green triangles.

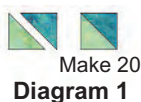

Make 20
Diagram 1

2. Four-patch sections. Referring to **Diagram 2** and noting orientation, stitch four half-square triangle units together to make one 5¾" x 5¾" section. Make a total of four sections.

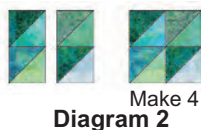

Make 4
Diagram 2

3. Following **Diagram 3**, sew a 3½" light blue/green triangle to each dark side of a half-square triangle unit. Repeat to make a second unit. In the same manner, stitch a 3½" dark triangle to each light side of a half-square triangle unit.

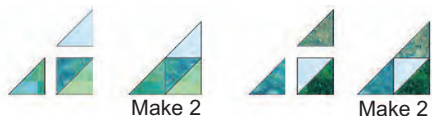

Make 2
Diagram 3

Repeat to make a second unit. Referring to **Diagram 4**, sew a 6⅛" pale sea foam triangle to each unit to complete two 5¾" x 5¾" light sections and two 5¾" x 5¾" dark sections.

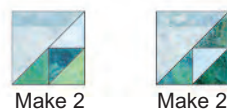

Make 2
Diagram 4

4. Following the **Ocean Wave Block Diagrams** and noting orientation, stitch two four-patch sections, one light section, and one dark section together into two rows of two sections each. Press seams in opposing directions, then sew the rows together. Stitch a 4½" x 11" pale sea foam strip to each of two opposite sides, then sew a 4½" x 19" pale sea foam strip to each of the remaining sides to complete one 19" x 19" block. Repeat to make a second block.

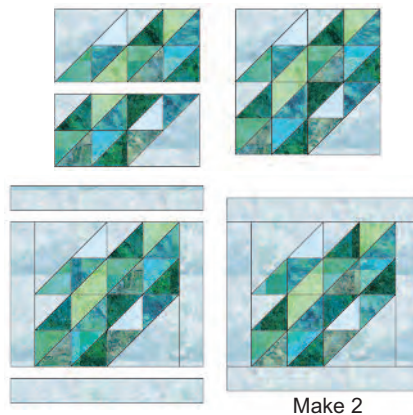

Ocean Wave Block Diagrams

Striped Block Assembly

1. Following the **Striped Block Diagrams**, stitch eight 2" x 14½" strips lengthwise together. Sew a 1½" x 14½" dark green strip to the top and another to the bottom. Press all seams in the same direction. Stitch a 2¾" x 14½" pale sea foam strip to each of two opposite sides, then sew a 2¾" x 19" pale sea foam strip to each remaining side to complete one 19" x 19" block. Repeat to make a second block.

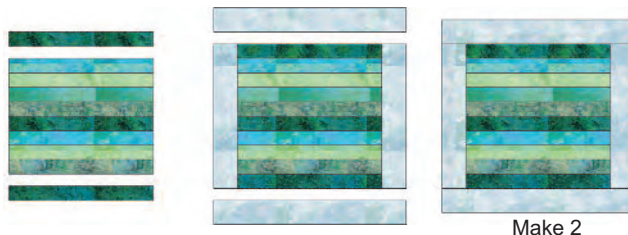

Striped Block Diagrams

Assembly

1. Pin one Ocean Wave block right sides together with a striped block, raw edges even. Use a ½" seam allowance to stitch around all four sides, leaving a 6" to 8" opening on one side. Turn right side out and insert pillow form or fiberfill through the opening, then hand sew the opening closed. Repeat to make a second pillow.